

Advanced Word Processing

Microsoft Word 2010



Important Notice

All candidates who follow an ICDL/ECDL course must have an official ICDL/ECDL Registration Number (which is proof of your Profile Number with ICDL/ECDL and will track all tests taken). Without such a Registration Number, no tests can be taken and the candidate will not be able to obtain an International Computer Driving Licence, nor any other form of certificate or recognition for the course.

Registration Numbers are obtainable from ICDL/ECDL Training and Testing Centres or directly from Specto

This Manual was compiled by:

Marianne Lubbe

Published by:

Let's Do It!

PO Box 589, Melkbosstrand, 7437

Phone: +27 (0) 21 553 5455

E-Mail: leonard@letsdoit.co.za

Revised Edition 2015

First Edition 2011

Published in the Republic of South Africa, Cape Town

ISBN: 978-1-920557-07-2

Copyright © Let's Do It! 2003

All rights reserved. This publication and accompanying materials, or any part thereof, may not be reproduced, or transmitted in any form or by any means, electronic or mechanical including storage in an information retrieval system, recording, photocopying, or otherwise without express written permission from *Let's Do It! (Publisher)* or the *authors*. This publication may not be circulated in any form of binding or cover other than that in which it is published and without a similar condition imposed on any subsequent purchaser or user.

Disclaimer

European Computer Driving Licence, ECDL, International Computer Driving Licence, ICDL, e- Citizen and related logos are all registered Trade Marks of The European Computer Driving Licence Foundation Limited ("*ECDL Foundation*").

Let's Do It is an entity independent of Specto and is not associated with ECDL Foundation or Specto in any manner. This courseware may be used to assist candidates to prepare for the ECDL Foundation Certification Programme as titled on the courseware . Neither Specto nor Let's Do It Education Centre warrants that the use of this courseware publication will ensure passing of the tests for that ECDL Foundation Certification Programme. This courseware publication has been independently reviewed and approved by Specto as covering the learning objectives for the ECDL Foundation Certification Programme

Confirmation of this approval can be obtained by reviewing www.specto.co

The material contained in this courseware publication has not been reviewed for technical accuracy and does not guarantee that candidates will pass the test for the ECDL Foundation Certification Programme. Any and all assessment items and/or performance-based exercises contained in this courseware relate solely to this publication and do not constitute or imply certification by ECDL Foundation in respect of the ECDL Foundation Certification Programme or any other ECDL Foundation test. Irrespective of how the material contained in this courseware is deployed, for example in a learning management system (LMS) or a customized interface, nothing should suggest to the candidate that this material constitutes certification or can lead to certification through any other process than official ECDL Foundation certification testing.

For details on sitting a test for an ECDL Foundation certification programme, please contact your country's designated National or visit ECDL Foundation's website at www.ecdl.org.

Candidates using this courseware must be registered with the National Operator before undertaking a test for an ECDL Foundation Certification Programme. Without a valid registration, the test(s) cannot be undertaken and no certificate, nor any other form of recognition, can be given to a candidate. Registration should be undertaken with your country's designated National Operator at an Approved Test Centre.

Let's Do It!

How to use this Manual

Using this manual you will encounter the following features:



Let's Remember!

- **Take note of the informative reminders.**

Let's Do It!

Practical Exercises.

This is a practical guide for anyone using *Microsoft® Office 2010* software.

The data associated with these exercises must be downloaded from Specto website. Go to: www.specto.co/data. Follow the on screen instructions to download the appropriate data file. Copy and paste the complete Let's Do It! folder to the hard drive (C-Drive) of your computer. Open the templates from this folder. A separate folder can be created to save completed exercises if necessary

This manual was written using *Windows® 7*. If a different operating system is used, some dialog boxes may look different, but the content is the same.

A screen resolution of *1366 x 768* was used in compiling this manual. Working in a different screen resolution, or with an application window which is not maximized, will change the look of the *Office 2010 Ribbon*. The *Ribbon* appearance is dynamic, as it will change to fit the space available. For example, the full *Ribbon* may show a group containing several options, but if space is restricted it may show a single button that you need to click to see the same options.

Table of Contents

Module Goals.....	1
Formatting.....	1
Text.....	1
Apply Text Wrapping.....	1
Examples of text wrapping.....	2
Position the Graphical Object.....	3
Click and Type.....	3
Turn On the Click and Type Feature.....	3
Use Click and Type.....	4
Text Wrapping for Tables.....	4
Find and Replace.....	6
Find Font Formats.....	6
Replace Font Formats.....	7
Find and Replace Paragraph Formats.....	8
Find and Replace Paragraph Marks.....	8
Find and Replace Page Breaks.....	9
Paste Special.....	10
Paragraphs.....	11
Line Spacing.....	11
Paragraph Pagination.....	12
Apply Paragraph Pagination.....	12
Remove Paragraph Pagination.....	13
Outline Numbering in Multi-Level Lists.....	13
Apply Outline Numbering.....	14
Modify Outline Numbering.....	15
Styles.....	16
Create a Character Style.....	16
Modify a Character Style.....	18
Update a Character Style.....	18
Create a Paragraph Style.....	18
Modify a Paragraph Style.....	19
Update a Paragraph Style.....	20
Columns.....	20
Apply Multiple Columns.....	20
Change the Number of Columns in a Column Layout.....	21
Change Column Widths.....	21
Insert or Remove Lines between Columns.....	21
Insert a Column Break.....	22
Tables.....	22
Apply a Table Style.....	22
Merge Cells in a Table.....	23
Split Cells in a Table.....	23
Change Cell Margins.....	24
Change Cell Alignment.....	24
Text Direction in a Cell.....	25
Repeat Heading Row at the Top of Each Page.....	25
Allow Row(s) to Break Across Pages.....	25
Sort Data in a Table.....	26
Sort Data by One Column.....	26

Sort Data by Multiple Columns	27
Convert Delimited Text to a Table	27
Convert a Table to Text	28
Referencing	30
Captions.....	30
Add a Caption to an Object or Table	30
Add a Caption Label	31
Delete a Caption Label.....	31
Change the Caption Number Format	32
Footnotes and Endnotes.....	32
Insert a Footnote.....	32
Insert an Endnote	32
Modify a Footnote or Endnote	33
Convert a Footnote to an Endnote	34
Convert an Endnote to a Footnote	34
Reference Tables and Indexes	35
Table of Contents	35
Create a Table of Contents.....	35
Update a Table of Contents	36
Table of Figures	37
Create a Table of Figures	37
Update a Table of Figures	37
Index	37
Mark a Main Entry or Subentry for the Index.....	38
Create an Index Based on Marked Entries.....	38
Update an Index.....	39
Delete a Marked Index Entry	39
Bookmarks and Cross-References.....	39
Add a Bookmark.....	39
Delete a Bookmark	40
Create a Cross-Reference.....	40
Create a Cross-Reference to a Bookmark	40
Create a Cross-Reference to a Heading.....	41
Create a Cross-Reference to a Numbered Item	41
Create a Cross-Reference to a Table or Figure	42
Delete a Cross-Reference	42
Add a Cross-Reference to an Index Entry	43
Enhancing Productivity	44
Using Fields	45
Insert a Field.....	45
Insert Author and FileName Fields	45
Insert FileSize Field	45
Insert Fill-In Field.....	46
Delete a Field	48
Insert a Sum Formula in a Table	48
Change the Field Format.....	48
Lock and Unlock a Field	49
Update a Field	49
Forms	50
Set Up Word for Creating Forms.....	50
Common Form Fields.....	50
Create a Form	50

Drop-Down Form Field	51
Text Form Field	51
Check Box Form Field	51
Protect a Form	52
Modify a Form.....	52
Add Help Text to a Form.....	52
Modify a Template	53
Mail Merge.....	55
Edit a Mail Merge Recipient List	55
Sort a Mail Merge Recipient List.....	57
Insert ASK Fields.....	58
Insert If...Then...Else Fields	60
Use Merge Criteria in a Mail Merge	61
Linking and Embedding	64
Insert a Hyperlink to an Existing File or Web Page	64
Insert a Hyperlink to a Place in the Same Document.....	65
Edit a Hyperlink	66
Remove a Hyperlink.....	66
Link Data from a Document or Application and Display as an Icon	66
Update, Break a Link	66
Update a Link	67
Break a Link	68
Embed Data into a Document as an Object	68
Edit Embedded Data	69
Delete Embedded Data.....	70
Automation.....	70
Apply Automatic Text Formatting	70
AutoFormat	71
AutoFormat As You Type	71
Create Automatic Text Correction Entries.....	71
Modify Automatic Text Correction Entries	72
Delete Automatic Text Correction Entries	73
Create Automatic Text Entries.....	73
Insert Automatic Text Entries	74
Modify Automatic Text Entries	74
Delete Automatic Text Entries	74
Macros.....	76
Record a Simple Macro	76
Run a Macro	78
Assign a Macro to a Custom Button	78
Collaborative Editing.....	80
Tracking and Reviewing.....	80
Turn Track Changes On or Off	80
Accept or Reject Changes in a Document	81
Comments	82
Insert Comments in a Document	82
Delete a Comment.....	82
Hide or Show Comments	82
Hide Comments	82
Show Comments.....	82
Compare and Merge Documents.....	83
Master Documents.....	85

Create a New Master Document	85
Insert a Subdocument	86
Remove a Subdocument	87
Text Outline	87
Security	89
Add Password Protection for a Document.....	89
Add a Password to Open a Document	89
Add a Password to Modify a Document	90
Remove a Password	90
Protect a Document to Only Allow Track Changes or Comments	91
Prepare Outputs	92
Sections	92
Types of Section Breaks.....	93
Create Section Breaks in a Document	92
Delete Section Breaks in a Document	93
Modify Section Breaks in a Document	93
Changes Settings for a Specific Section	93
Change Page Orientation for a Section.....	93
Change Page Layout for a Section.....	94
Change Margins for a Section.....	94
Document Setup	95
Apply Different Headers and Footers	95
Apply Different Headers and Footers to Sections.....	95
Apply a Different Header or Footer to the First Page.....	95
Apply Different Headers or Footers for Odd and Even Pages	96
Add a Watermark to a Document.....	96
Modify a Watermark in a Document.....	98
Delete a Watermark in a Document.....	98
Additional Exercises	99

Module Goals

Advanced Word Processing requires the candidate to use the word processing application to produce advanced document outputs.

The candidate shall be able to:

- ↗ Apply advanced text, paragraph, column and table formatting. Convert text to a table and vice versa.
- ↗ Work with referencing features like footnotes, endnotes and captions. Create tables of contents, indexes and cross-references.
- ↗ Enhance productivity by using fields, forms and templates.
- ↗ Apply advanced mail merge techniques and work with automation features like macros.
- ↗ Use linking and embedding features to integrate data.
- ↗ Collaborate on and review documents. Work with watermarks, sections, and headers and footers in a document.

Formatting

The following outcomes will be covered in this category:

- ↗ Apply text wrapping options
- ↗ Use find and replace options
- ↗ Use paste special options
- ↗ Apply line spacing within paragraphs
- ↗ Paragraph pagination options
- ↗ Outline numbering in multilevel lists
- ↗ Character and paragraph styles
- ↗ Column layouts
- ↗ Column breaks
- ↗ Table styles
- ↗ Merging and splitting cells in a table
- ↗ Cell margins, alignment and text direction
- ↗ Repeat heading rows in a table
- ↗ Rows in a table breaking across pages
- ↗ Sorting data in a table
- ↗ Converting delimited text to a table
- ↗ Convert a table to text

Text

Apply Text Wrapping

Text automatically wraps (flows) around graphical objects and tables. How the text wraps, can be changed as desired. Use the tools on the *Ribbon* or the *Click and Type* feature to apply text wrapping.

1. Insert a picture, image, chart, diagram or drawn object.
2. Ensure the graphical object is selected. When a graphical object is selected, a contextual tab will appear, e.g. *Picture Tools* ↗ *Format*.
3. On the *Format* tab, in the *Arrange* group, click the *Wrap Text* drop-down menu and select the appropriate option, e.g. *Square*.

Select *More Layout Options* to open the *Layout* dialog box. Click the *Text Wrapping* tab for more options. If text should for example only wrap to the left of a graphical object, select *Left only*.

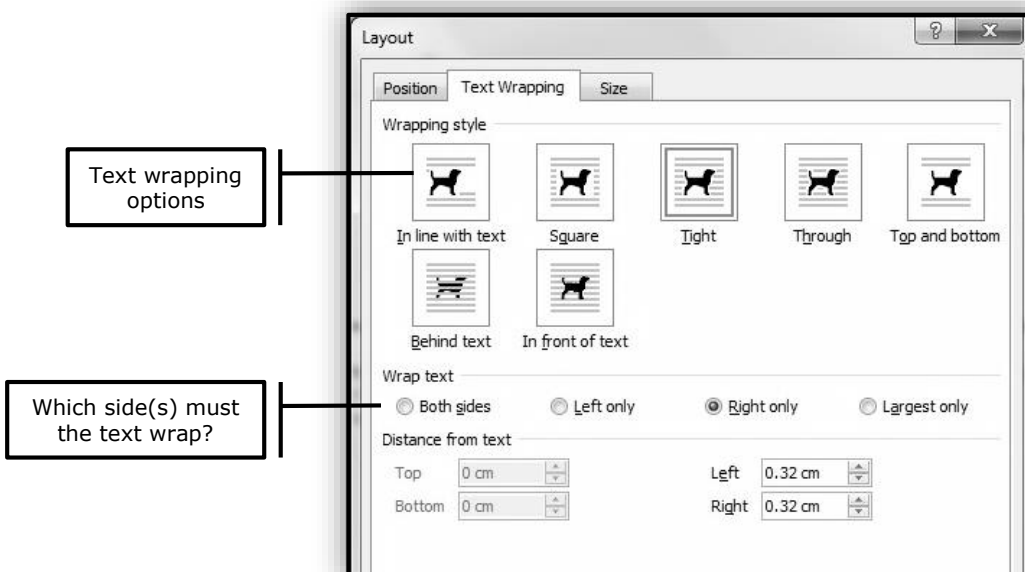
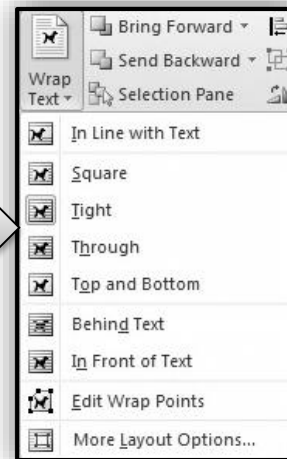

Examples of text wrapping:

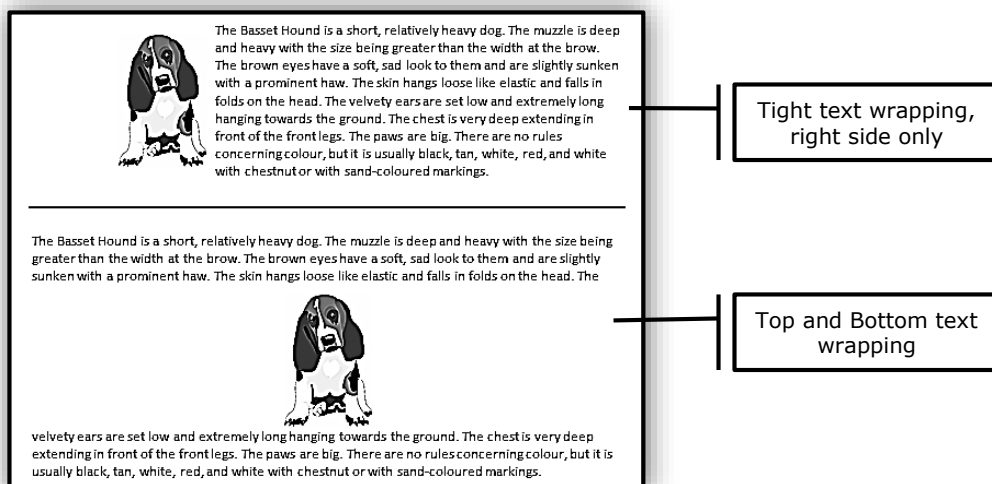
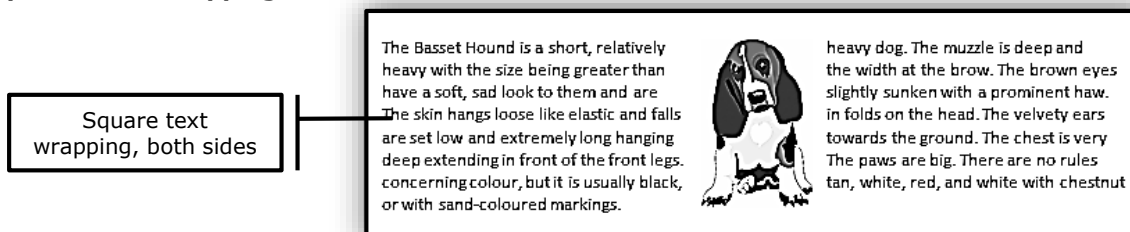

Position a Graphical Object

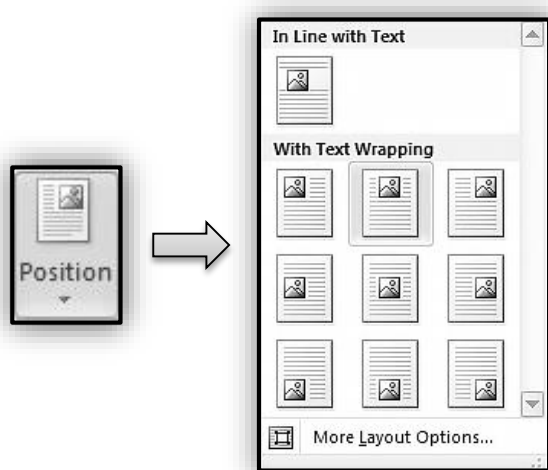

A graphical object can be placed on a specific position on the page. The text wrapping will be set automatically. Click *More Layout Options* to change the text wrapping.

1. Select the graphical object.
2. On the contextual *Format* tab, in the *Arrange* group, click the *Object Position* drop-down menu.
3. Select a position option from the list.
4. Text wrapping will be set as *Square*.



Let's Remember!

When a graphical object is inserted, the default text wrapping is *In Line with Text*.

Click and Type

Click and Type is a feature which helps make it easier to position text at exact points on the page. When you move the cursor around the blank page, depending on the part of the page you place the mouse pointer; you will see a small symbol for left-align, centre or right-align as part of the cursor. Whenever you see one of these special cursors (I-beams), double-click to start typing exactly where the cursor is positioned. The small alignment icon indicates what kind of text alignment will be applied when you start typing. This feature can be used to create left-aligned, centred and right-aligned text on the same line of the document.

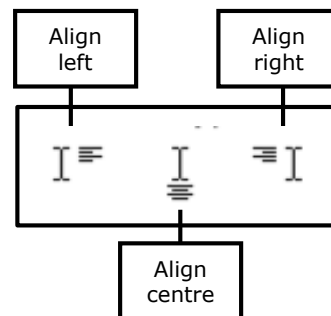

Turn On the Click and Type Feature

1. Click the *File* tab and then select *Options*.
2. Click the *Advanced* tab on the left-hand side.
3. Select *Enable click and type*.
4. Click *OK*.

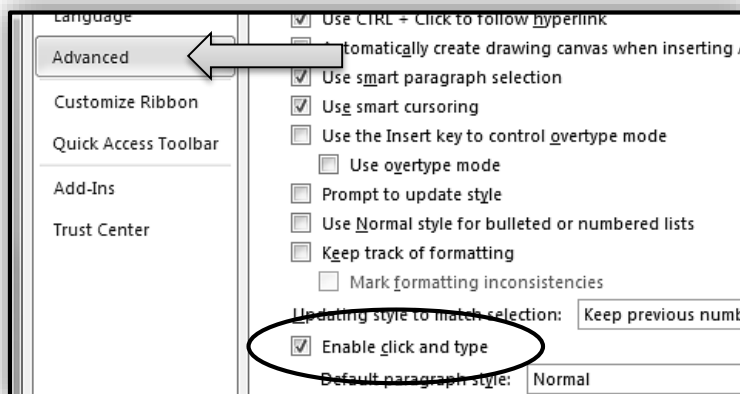

Let's Remember!

Click and type is only available in the following view modes: **Print Layout and Web Layout**.

Use Click and Type

1. Open a blank word processing document.
2. Ensure the current view is *Print Layout*.
3. Move the mouse pointer to any position on the page.
4. Double-click to enable *Click and Type*. Enter the relevant text or graphical object.





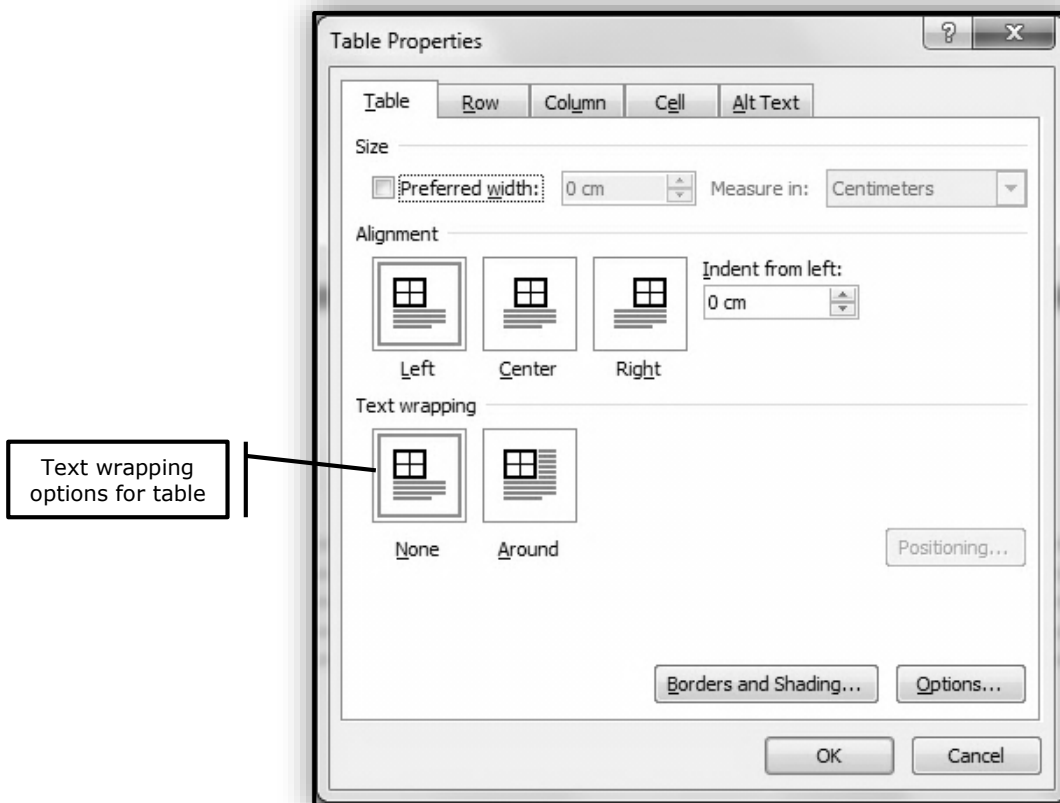



Text Wrapping for Tables

1. Insert the table and enter all the necessary text.
2. Right-click anywhere in the table and select *Table Properties* from the shortcut menu. The *Table Properties* dialog box will open.
3. In the *Text wrapping* section, select *None* or *Around*. The default setting is *None*.
4. Click *OK*.



West Africa is west of an imagined north-south axis lying close to 10° east longitude. The Atlantic Ocean forms the western and southern borders of the region. The northern border is the Sahara Desert, with the Ranishany Bend generally considered the northernmost part of the region. The eastern border is less precise, with some placing it at the Benue Trough, and others on a line running from Mount Cameroon to Lake Chad.

Colonial boundaries are reflected in the modern boundaries between contemporary West African nations, cutting across ethnic and cultural lines, often dividing single ethnic groups between two or more countries.

	Mali		Cote d'Ivoire
	Niger		Benin
	Senegal		Sierra Leone
	Ghana		Togo

Despite the wide variety of cultures in West Africa, from Nigeria through to Senegal, there are general similarities in dress, cuisine, music and culture that are not shared extensively with groups outside the geographic region.

Text wrapped around table

Let's Do It! ⇨ 1

1. Open a new word processing document.
2. Place the cursor at about 6 cm from the top of the page and 2 cm from the left of the page (do not include margins).
3. Insert the image called **speech.gif** contained in the *Let's Do It!* folder.
4. Size the image to 8 cm in height and 5.96 cm in width.
5. Position the image to the middle left of the page.
6. Enter the following text to the right of the image:

Tips for public speaking:

Know the material you will speak on.

Decide, what are the important things I must get across to the listener?

Write out your speech like you are talking to a friend.

Either have an outline or cards with key reminders of what to say.

Practice your talk in front of a mirror. Revise points that do not flow right.

7. Save the document as **Public Speaking**.
8. Close the document.

Let's Do It! ⇨ 2

1. Open a new word processing document.
2. Place the cursor in the centre of the page and type the following as shown:

**Effective leadership is putting first things first. Effective management is discipline,
carrying it out.
Stephen Covey**

**A cardinal principle of Total Quality escapes too many managers: you cannot
continuously improve interdependent systems and processes until you progressively
perfect interdependent, interpersonal relationships.
Stephen Covey**

3. Change the font type to Impact and the font size to 20 pt.
4. Choose a different text colour for each quote.
5. Save the document as **Quotes**. Close the document.

Let's Do It! ⇨ 3

1. Open the document called **Kenya**.
2. Change the wrapping of the image to *Top and Bottom*.
3. Position the image to the middle left of the page.
4. Change the text wrapping of the table to *Around*.
5. Move to the end of the document.
6. Insert the image **masai-mara.jpg** from the *Let's Do It!* folder.
7. Resize the image to 6.5 cm in height and 8.66 cm in width.
8. Change the text wrapping of the image to *Tight* and move the image to the right of the last paragraph in the document.
9. Save and close the document.